



FITZJOHN
SALES & LETTINGS

62 Hargate Way,
Hampton Hargate, Peterborough,
Cambridgeshire, PE7 8DS

Tel 01733 555520
info@fitzjohnstateagents.com
www.fitzjohnstateagents.com



56 Burdett Grove Whittlesey Peterborough PE7 1JG

£1,100 Per month



Having been redecorated throughout, new flooring and refitted en suite is this three bedroom end terraced house located in Whittlesey. Accommodation comprises gas central heating, single garage in nearby block, downstairs cloakroom, kitchen diner, lounge with French doors, three bedrooms, modern refitted en suite, family bathroom and garden to rear.



Entrance Hall 3.67m (12') x 2.00m (6'7") Stairs to first floor, door to:

Cloakroom 1.75m (5'9") x 0.77m (2'6") Window to front, radiator.

Living Room 4.52m (14'10") x 3.71m (12'2") Radiator, fitted carpet, TV point, coving to textured ceiling, double door to rear garden.

Kitchen/Diner 3.67m (12') x 2.69m (8'10") Window to front, radiator.

First Floor Landing Fitted carpet, textured ceiling.

Bedroom 3 2.90m (9'6") x 1.85m (6'1") Window to rear, radiator, fitted carpet, TV point, textured ceiling.

Bathroom Fitted with three piece suite comprising panelled bath with shower over, pedestal wash hand basin and low-level WC, tiled surround, radiator, vinyl flooring.

Bedroom 2 2.89m (9'6") x 2.69m (8'10") Window to rear, radiator, fitted carpet, TV point, textured ceiling.

Bedroom 1 3.30m (10'10") x 2.84m (9'4") Window to front, radiator, fitted carpet, TV point, textured ceiling, double door to built-in double wardrobe.

En Suite 1.80m (5'11") x 1.58m (5'2") Refitted with three piece suite comprising shower cubicle, pedestal wash hand basin and low-level WC tiled surround, window to front, vinyl flooring, textured ceiling, door to storage cupboard.

OUTSIDE:
Enclosed by wooden panelled fence, paved sun patio and mainly laid to lawn. Single garage with up and over door.

Area Map



Floor Plans

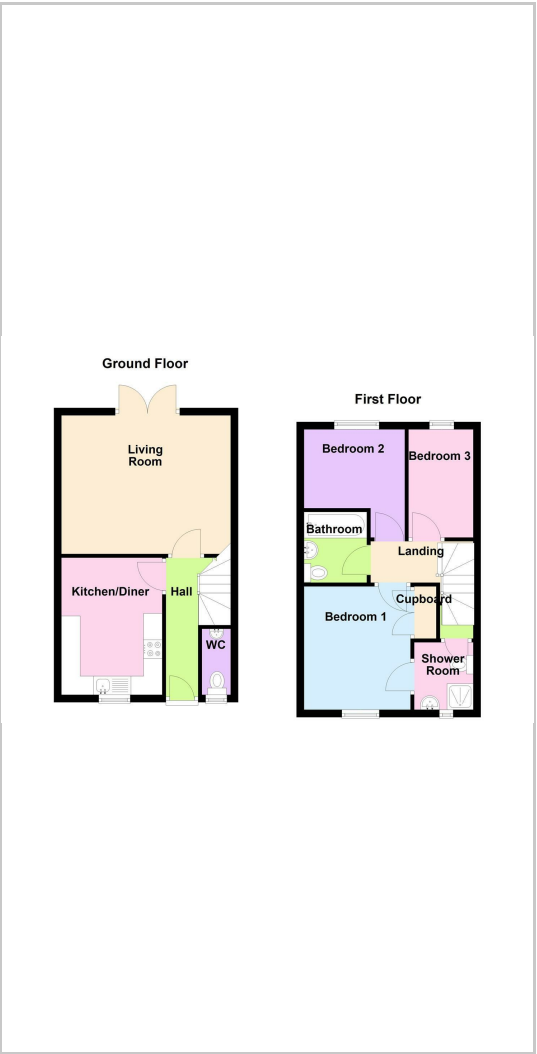

Energy Efficiency Graph

